

A

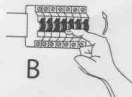
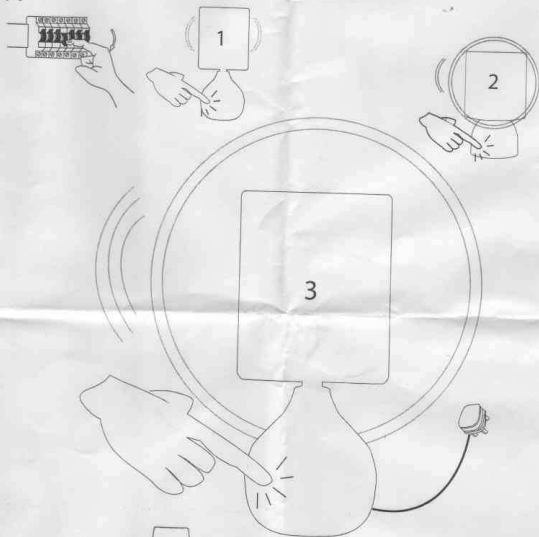

230V-
50HZ

B

Instructions for Touch Lamps

1. Always unplug the lamp before fitting or changing the bulb.
2. This table lamp is controlled by a touch dimmer.

Touching the metal body briefly will cause it to cycle through the following sequence:

- Off
- Low brightness
- Medium brightness
- Full brightness

To alter the brightness of your lamp, simply touch the metal body the required number of times.

NOTE: IF THE EXTERNAL FLEXIBLE CABLE OR CORD OF THIS LUMINAIRE IS DAMAGED IT SHALL BE EXCLUSIVELY REPLACED BY THE MANUFACTURER OR HIS SERVICE AGENT OR SIMILAR QUALIFIED PERSON.

3.